

Converted with BCL sasypdf Batchtrial version  
 To purchase go to <http://www.pdfonline.com/easy/pdfbatch/index.htm>

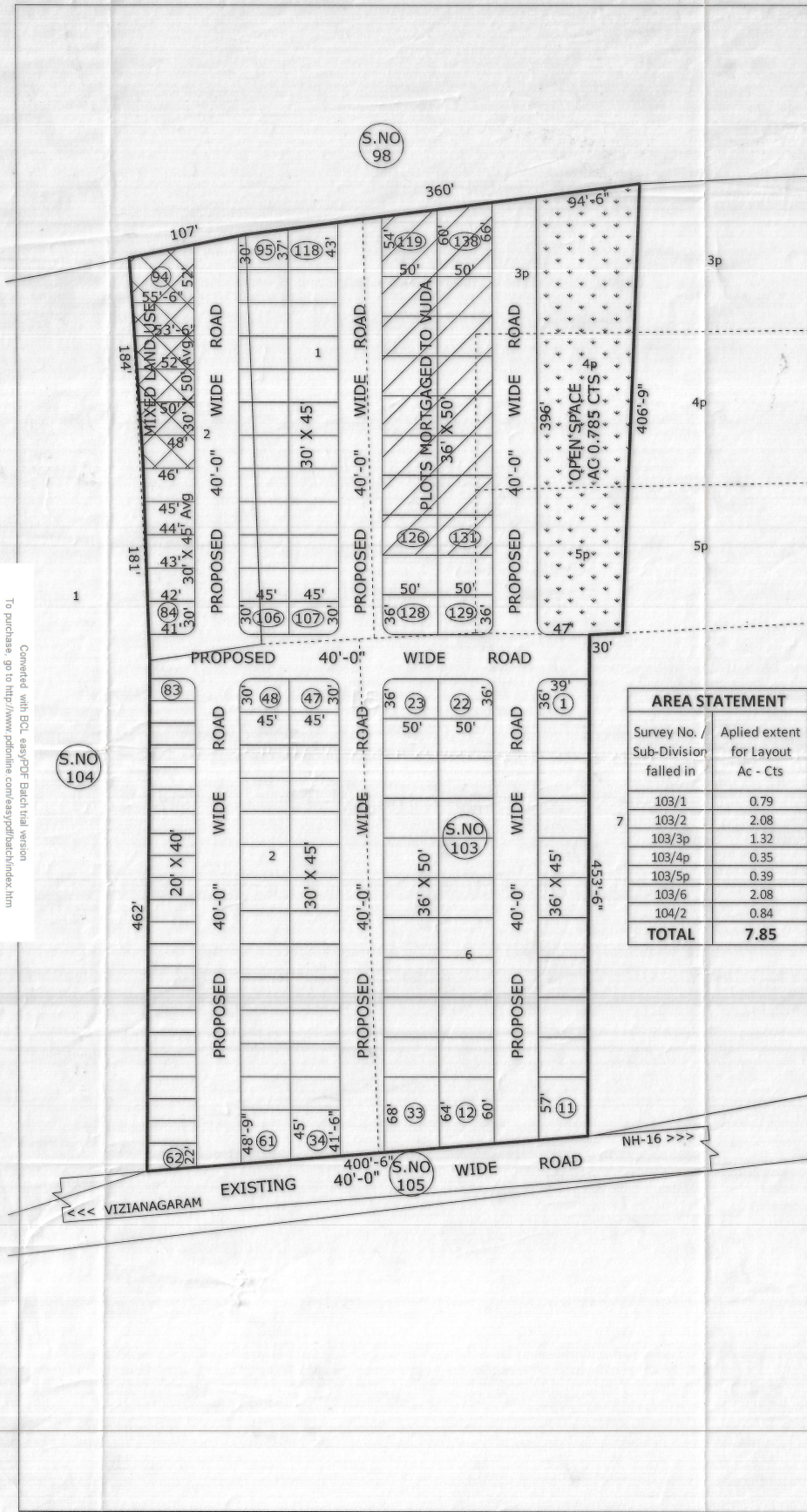

**PROPOSED LAYOUT PLAN FOR RESIDENTIAL PLOTS AN EXTENT OF AC 7.85 CTS IN S.Nos: 103p & 104p OF R.THIMMAPURAM VILLAGE DENKADA MANDAL VIZIANAGARAM DISTRICT.**  
 Belongs To: M/s.KRANTHI PROPERTIES

**LAND USE ANALYSIS :-**

SL.NO.	DESCRIPTION	EXTENT Ac.-cts.	PERCENTAGE
1.	PLOTTED AREA	4.39	} 58.98 %
2.	MIXED LAND USE AREA	0.24	
3.	ROADS AREA	2.435	31.02 %
4.	OPEN SPACE AREA	0.785	10.00 %
<b>TOTAL AREA</b>		<b>7.85</b>	<b>100.00 %</b>

**PLOTS DETAILS :-**

SL.NO.	PLOT SIZE	PLOT AREA IN Sq Yds	NO OF PLOTS
1	36' X 50'	200.00	42
2	36' X 45'	180.00	11
3	30' X 50'	166.66	06
4	30' X 45'	150.00	57
5	20' X 40'	88.88	22
<b>TOTAL NO OF PLOTS</b>			<b>138</b>

PROPOSED LAYOUT BOUNDARY.

FILE L.T.NO: 11101 / 2015 / L8  
 L.P.NO: 31/ 2016

**SCALE :**  
 1" = 66'-0"



**PLOTS MORTGAGED TO VUDA**  
 PLOT NO'S: 119 TO 126 & 131 TO 138  
 TOTAL EXTENT: AC 0.71 CTS  
 NO. OF PLOTS: 16

AREA STATEMENT	
Survey No. / Sub-Division fallen in	Applied extent for Layout Ac - Cts
103/1	0.79
103/2	2.08
103/3p	1.32
103/4p	0.35
103/5p	0.39
103/6	2.08
104/2	0.84
<b>TOTAL</b>	<b>7.85</b>

FOR KRANTHI PROPERTIES  
*P.K.R. Lakshmi*  
 Managing Partner

OWNER'S SIGN.

*H. Lakshmi Narayana*  
**H. LAKSHMI NARAYANA**  
 VUDA Licensed Civil Engineer / Surveyor  
 Regd. No. 104/2015-2018  
 Visakhapatnam Urban Development Authority  
 VISAKHAPATNAM  
 Ph. : 7093344567

LICENSED SURVEYOR

*A. Ramesh*  
 A.D.M

*[Signature]*  
 Planning Officer - 11

*[Signature]*  
 Chief Urban Planner

*[Signature]*  
 VICE CHAIRMAN

**VISAKHAPATNAM URBAN DEVELOPMENT AUTHORITY**